

On-Call® Lancing Device

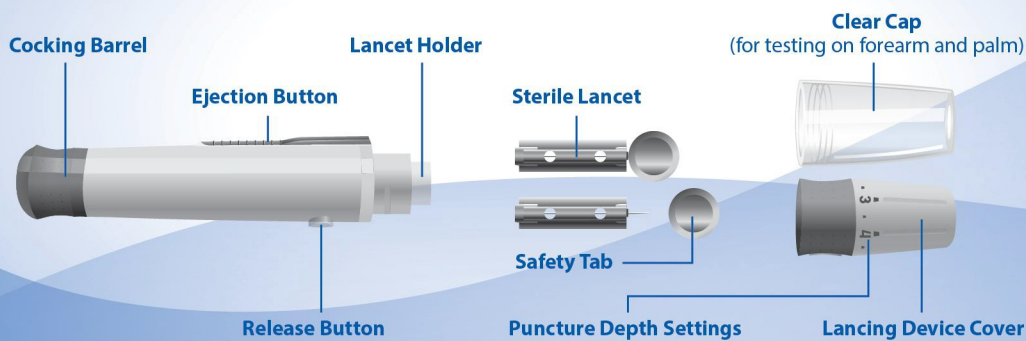

Before Testing:

Choose a clean, dry work surface. Familiarize yourself with the procedure and make sure you have all the items needed to obtain a drop of blood.

Wipe the test site with an alcohol swab or soapy water. Use warm water to increase blood flow if necessary. Then dry your hands and the test site thoroughly. Make sure there is no alcohol, soap or lotion on the test site.

Sampling from the fingertip:

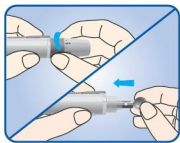

1. Unscrew cover and insert lancet.



2. Insert the lancet firmly into the lancing device; twist open the safety tab and then pull it off.

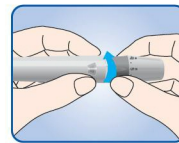

3. Screw the cover back and make sure the cover is fully sealed.

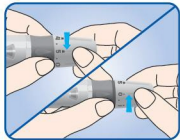

4. Select puncture depth: 0-1.5 for delicate skin; 2-3.5 for normal skin; 4-5 for calloused or thick skin. (Note: greater pressure against the finger will also increase puncture depth)



5. Pull cocking barrel back till you hear a click sound and the release button will change to orange color. Now it's loaded and ready to obtain blood drop.

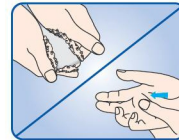

6. Make sure your hand is clean and dry; warm water washing & proper massage will increase blood flow.



7. Release the button to prick your fingertip; Obtain required volume while avoid smearing.



8. Unscrew the cover and insert the lancet needle into the safety tab.

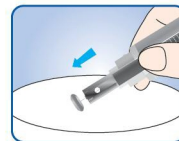

9. Slide the ejection button to discard the used lancet.

CARE OF THE LANCING DEVICE

Clean the lancing device using a soft cloth with mild soap and warm water as required. Use 70% Isopropyl Alcohol to disinfect the lancing device. Carefully dry the lancing device. Do not immerse the lancing device in liquid.

PRECAUTIONS

- Do not use the lancet if the safety tab is missing or loose when you take the lancet out of the bag.
- Do not use the lancet if the needle is bent.
- Use caution whenever the lancet needle is exposed.
- Never share lancets or the lancing device with other people.
- In order to reduce the risk of infection from prior use of the instrument, always use a new, sterile lancet. Do not reuse lancets.
- Avoid getting the lancing device or lancets dirty with hand lotion, oils, dirt or debris.
- Any serious incident that has occurred in relation to the device should be reported to ACON and your competent authority.
- Lancets are non-reusable and must be discarded properly after use.



Exclusively Distributed By:
AJJ Healthcare Management Pte Ltd
Tel: +65 6908 4252
www.ajjhealthcare.com



ACON Laboratories, Inc.
5850 Oberlin Drive, #340
San Diego, CA 92121, USA
www.aconlabs.com

On-Call® GenTouch Lancing Device



Before Testing:

Choose a clean, dry work surface. Familiarize yourself with the procedure and make sure you have all the items needed to obtain a drop of blood.

Wipe the test site with an alcohol swab or soapy water. Use warm water to increase blood flow if necessary. Then dry your hands and the test site thoroughly. Make sure there is no alcohol, soap or lotion on the test site.

Sampling from the fingertip:

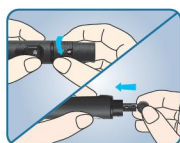

1. Unscrew cover and insert lancet.



2. Insert the lancet firmly into the lancing device; twist open the safety tab and then pull it off.



3. Screw the cover back and make sure the cover is fully sealed.

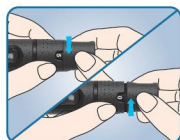

4. Select puncture depth: 0-1.5 for delicate skin; 2-3.5 for normal skin; 4-5 for calloused or thick skin. (Note: greater pressure against the finger will also increase puncture depth)



5. Pull cocking barrel back till you hear a click sound and the release button will change to yellow color. Now it's loaded and ready to obtain blood drop.

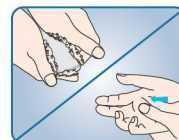

6. Make sure your hand is clean and dry; warm water washing & proper massage will increase blood flow.



7. Release the button to prick your fingertip; Obtain required volume while avoid smearing.



8. Unscrew the cover and insert the lancet needle into the safety tab.



9. Slide the ejection button to discard the used lancet.

CARE OF THE LANCING DEVICE

Clean the lancing device using a soft cloth with mild soap and warm water as required. Use 70% Isopropyl Alcohol to disinfect the lancing device. Carefully dry the lancing device. Do not immerse the lancing device in liquid.

PRECAUTIONS

- Do not use the lancet if the safety tab is missing or loose when you take the lancet out of the bag.
- Do not use the lancet if the needle is bent.
- Use caution whenever the lancet needle is exposed.
- Never share lancets or the lancing device with other people.
- In order to reduce the risk of infection from prior use of the instrument, always use a new, sterile lancet. Do not reuse lancets.
- Avoid getting the lancing device or lancets dirty with hand lotion, oils, dirt or debris.
- Any serious incident that has occurred in relation to the device should be reported to ACON and your competent authority.
- Lancets are non-reusable and must be discarded properly after use.



Exclusively Distributed By:
AJJ Healthcare Management Pte Ltd
Tel: +65 6908 4252
www.ajjhealthcare.com



ACON Laboratories, Inc.
5850 Oberlin Drive, #340
San Diego, CA 92121, USA
www.aconlabs.com